

ANEXO 1

Zonificación Urbana Los Cocos

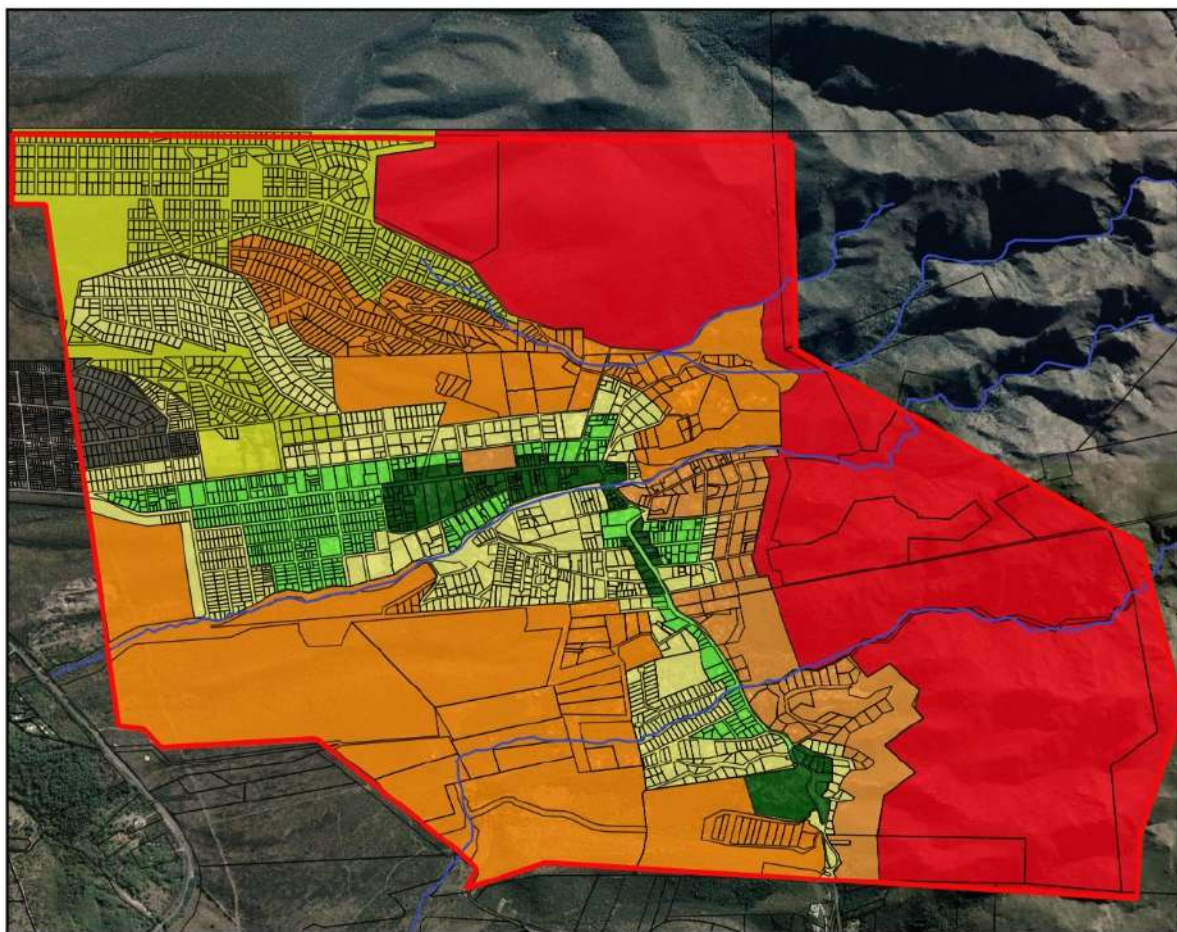

Referencias	
—	Arroyos
AMBIENTAL	
■	Zona Roja
■	Zona Naranja
■	Zona Naranja 2
■	Zona Amarilla
■	Zona Amarilla 2
■	Zona Verde
■	Zona Verde 2
■	Zona Industrial

0 250 500 m
1:15000

ANEXO 2

Mapa de Avenidas y Calles Principales de Los Cocos



- Referencias**
- Calles Principales
 - Calles Tipo 1
 - Calles Tipo 2
 - Radio Urbano
 - Arroyos
 - parcelas

0 250 500 m

1:16153

ANEXO GRAFICO 3

PLANOS LIMITES DE FACHADA

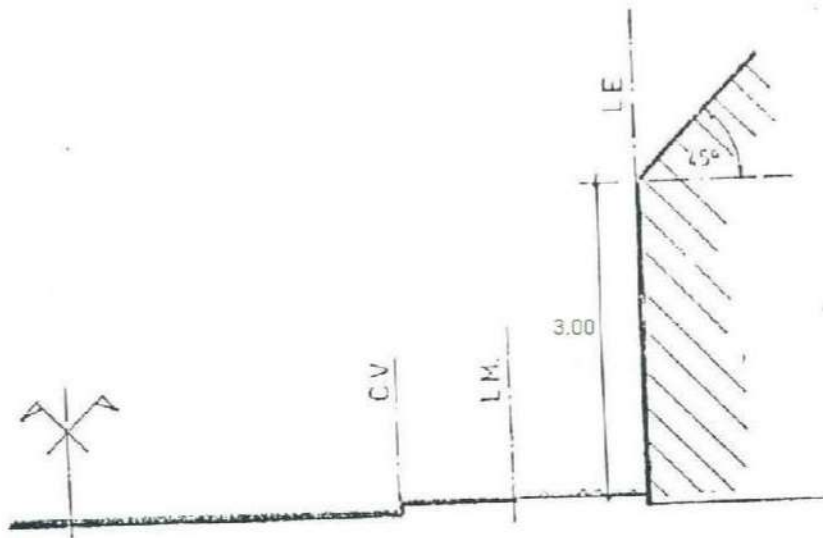

ANEXO GRAFICO 4

SALIENTES DE LA LINEA DE EDIFICACION

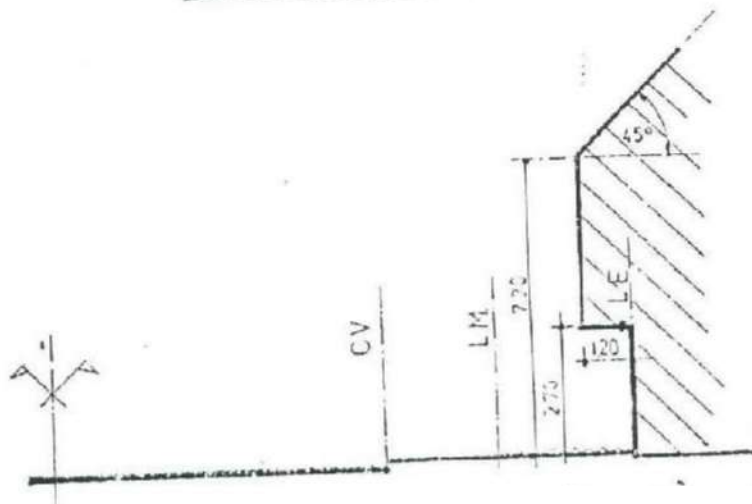

ANEXO GRAFICO 5

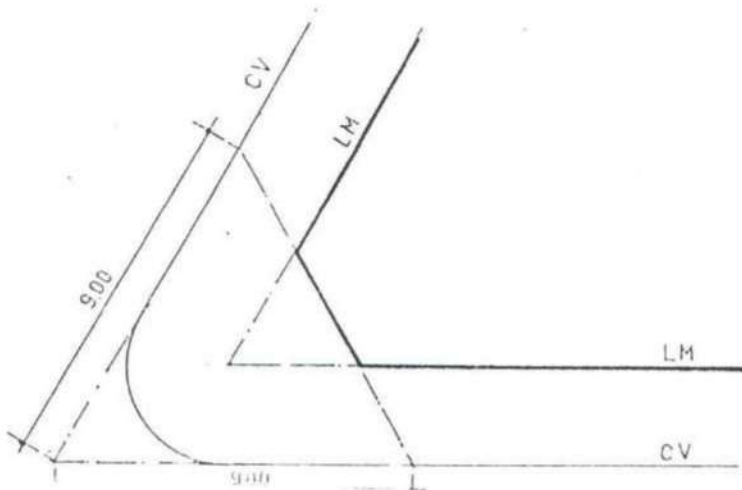
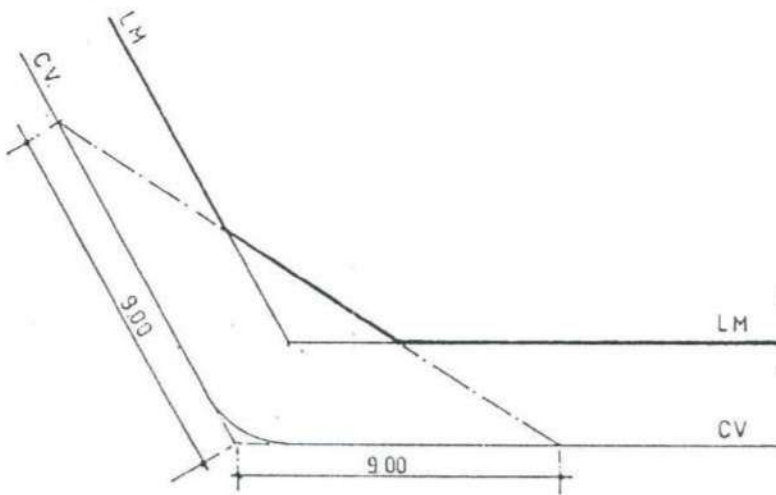
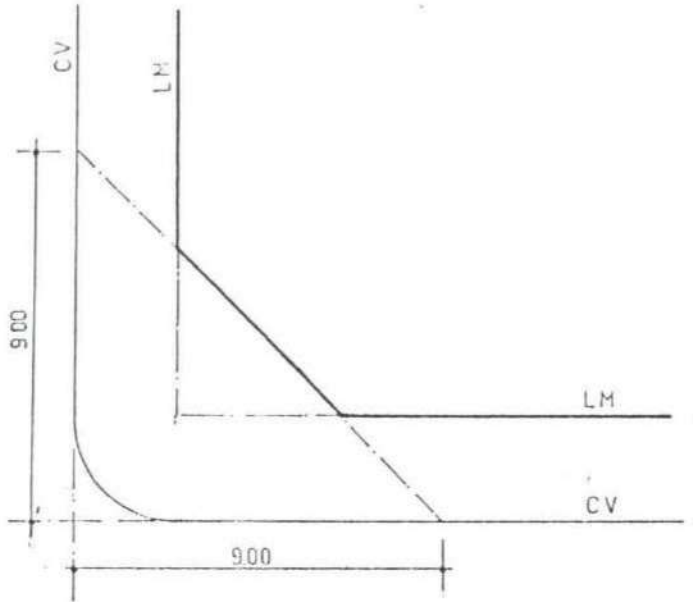

ANEXO GRAFICO 6

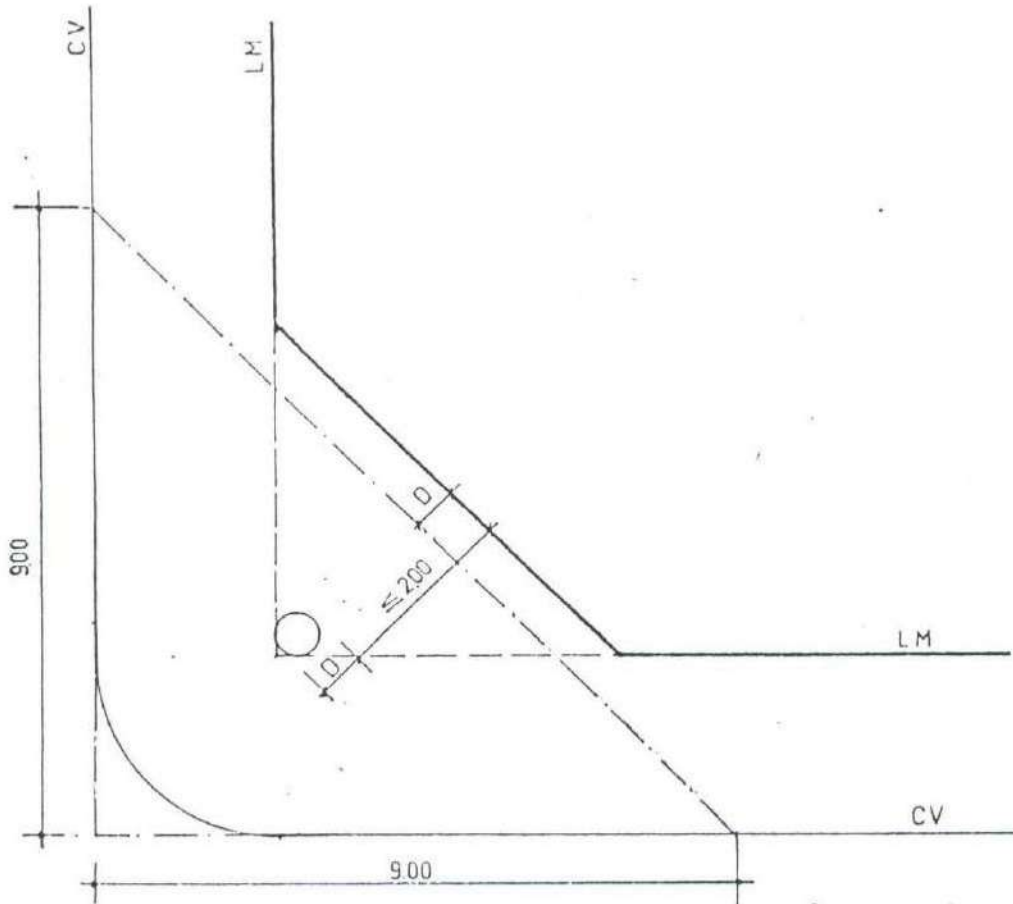

ANEXO GRAFICO 7

DE LOS PATIOS

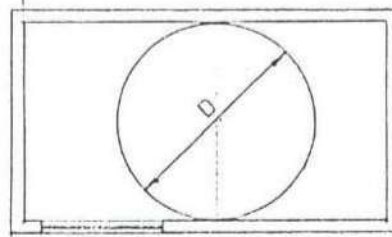
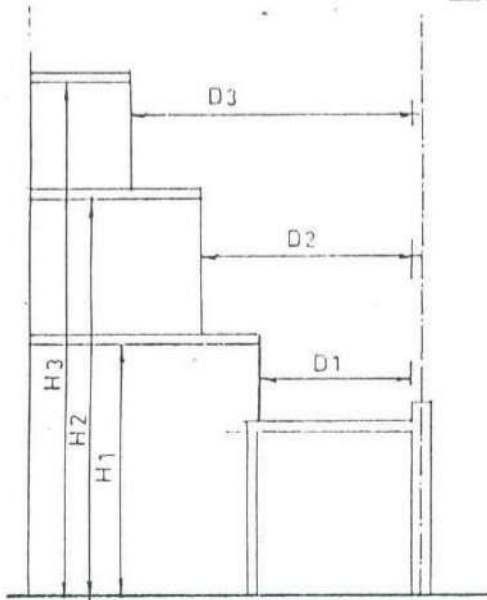

$$D = 1/5 H1 \geq 300$$

$$D = 1/5 H2 \geq 300$$

$$D = 1/5 H3 \geq 300$$

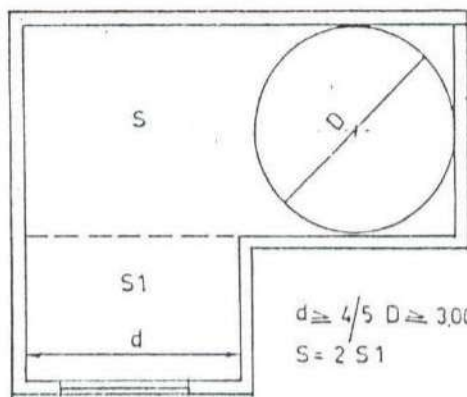
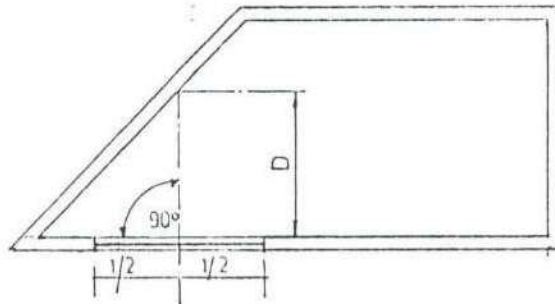

$$d \geq 4/5 D \geq 300$$

$$S = 2 S1$$

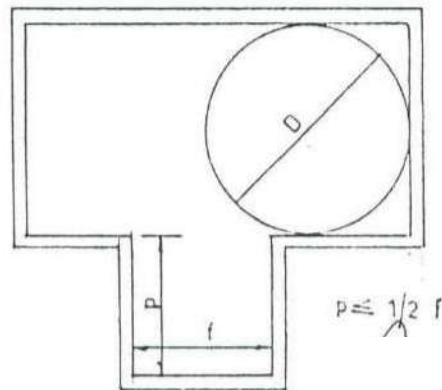

$$P \leq 1/2 f$$

PATIOS MANCOMUNADOS



ANEXO GRAFICO 8

C1

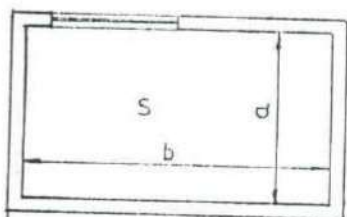

$$S = a \times b$$

C1

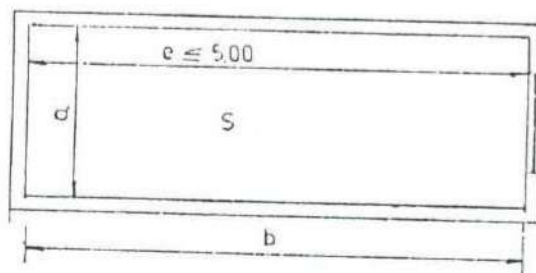

$$S = S1 + S2$$

$$\text{Si } e \geq 5,00; S = (S1 + S2) 1,2$$

C1

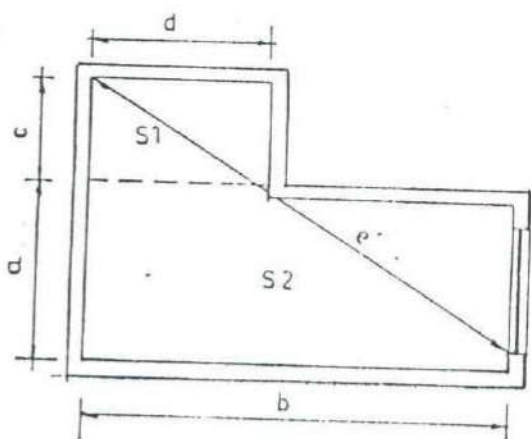

C2

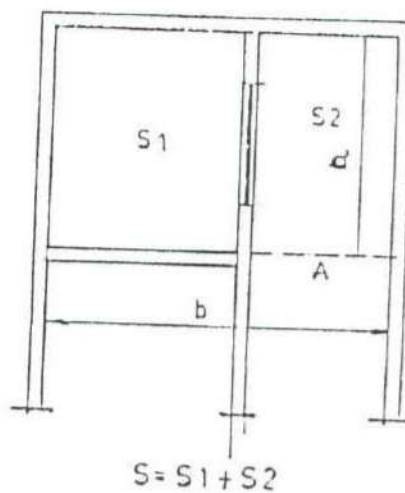

$$S = S1 + S2$$

C3

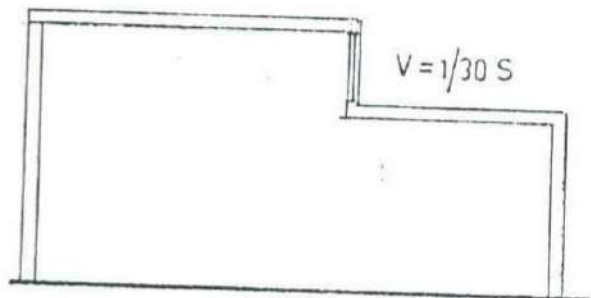

$$V = 1/30 S$$

ANEXO GRAFICO 10

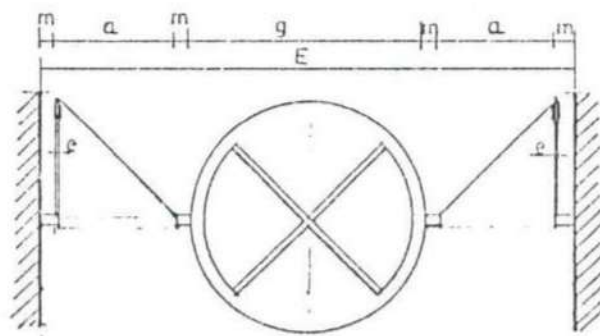
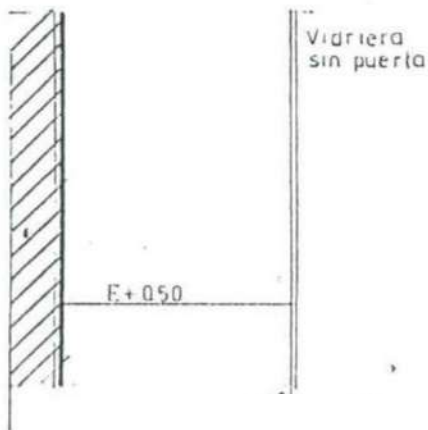
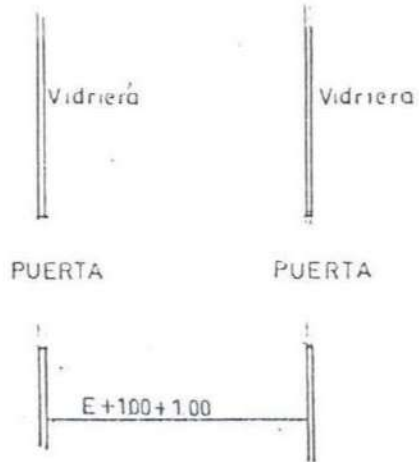
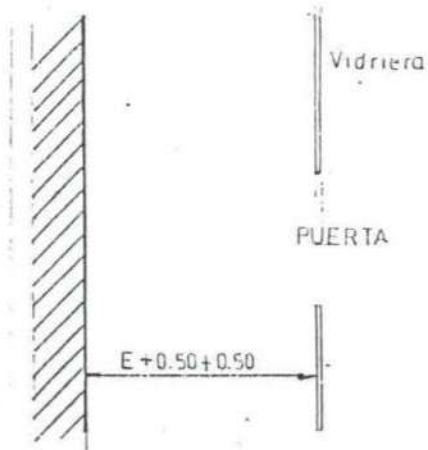
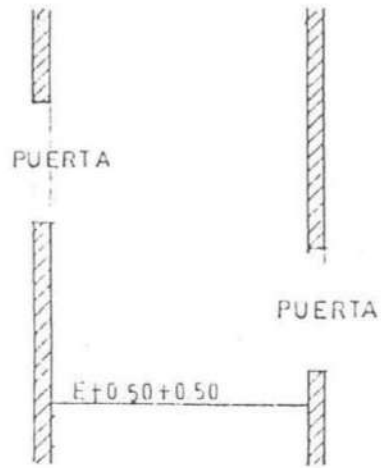
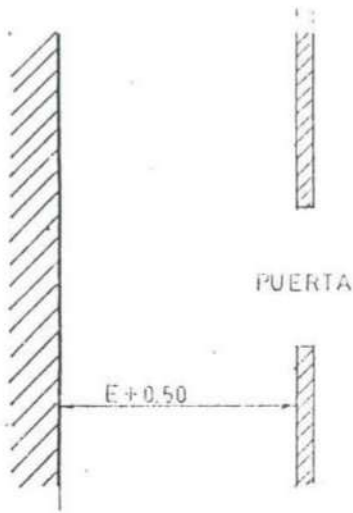

$$A \geq E - (4m + 2a + 1/2 g)$$

$$2a \geq 1/2 g$$

